

Using the App

1. Connect to the device

Welcome!
With the Matoha app, you can control your instruments as well save and manage your data.

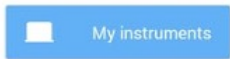
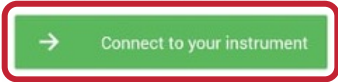

3. Choose 'Measurement interface'

✓ Ready to measure!

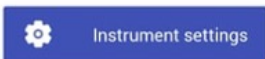

5. Add sample information such as the material.

Description	Description
Material	Select one ↓
Colour	↓
Photo	
Item weight (g)	grams

2. Scan & select your machine

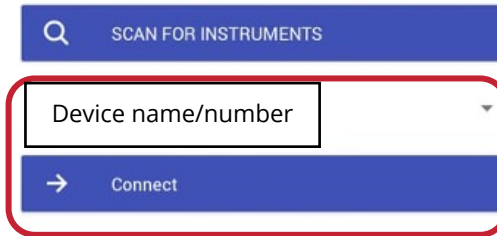

4. Scan your sample and select the collection to save into (ask your supervisor).

Result: PMMA(score: 2.81)

Infrared spectrum



Collection: Select a collection ↓

6. Press Save. Hold Save if the garment is the same as the measurement before to pair them (add to previous).



Collection:	Test collection 2 ↓
Description	Description

PlasTeo

Quick reference guide

Safety information

Please read the safety section in the user manual before using the device.



Keep device away from liquids



If any issue occurs, stop using the device and inform your supervisor (or Matoha).



Do not touch the sensor surface



Use a clean, dry cloth to clean the sensor if dirty

Instrument parts & operation

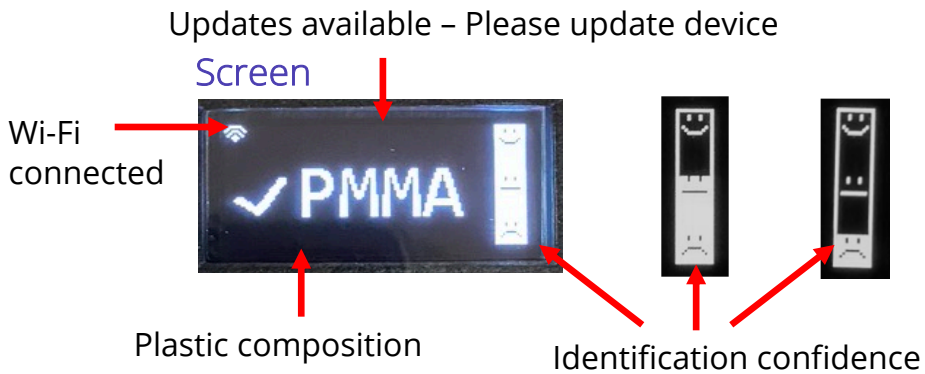
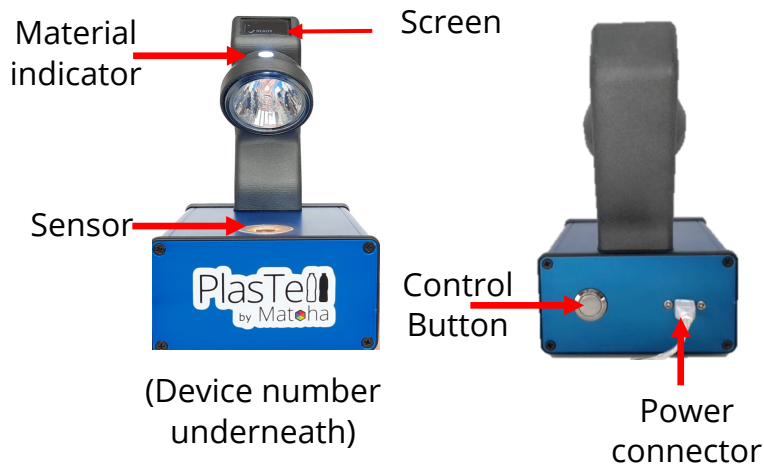

Turn on: plug in the power cable **Turn off:** unplug the power cable. **When starting,** the device will say "Calibrating". DO NOT place any samples onto the sensor until the device shows "Ready".

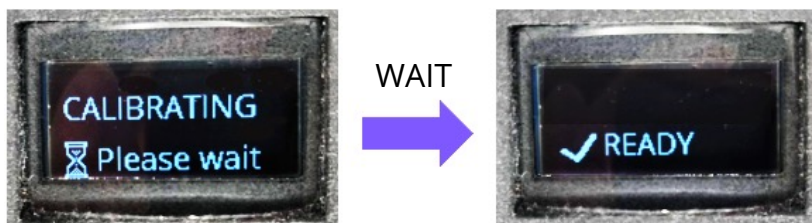

Measuring DOs and DON'Ts

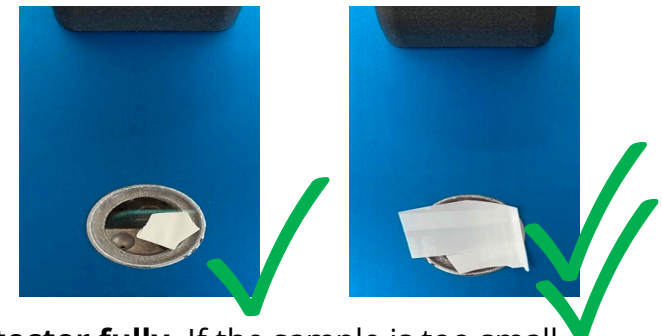

✓ **DO** cover the detector fully. If the sample is too small, place it on the right-hand side.

For further help, please refer to the User Manual or e-mail us at support@matoha.com © 2021 Matoha Instrumentation Ltd.